7 SPACE STANDARDS

In 1987, the County hired CRSS, Inc., to do a "Schematic Design Program." As part of the program 'space standards' were developed and implemented for the County Administration Building. Since then, the standards have been further developed and refined while being applied to remaining and new county buildings. Space standards are an important planning tool because they represent the County's position on how space is assigned and utilized. Space Standards are integrated in the plan for the following purposes:

- To pursue balance and equity in the assignment of space for similar purposes
- To correctly and adequately allocate space for designated uses
- To record and monitor the character, size and quality of the components of facilities which the County occupies
- To accommodate changes in staffing and technology needs in a cost effective manner, and appropriately measure and plan for future facilities needs

After the first round of department interviews during the creation of the SFMP, a comprehensive list of space standards was developed. These standards include personnel space, space based on occupancy, space based on square footage, and space ratios calculated on inmate bed count.

Since it would be impractical to illustrate standards for every type of facilities space, the standards shown represent a limited range of typical space needs, which are found in repetition across a wide variety of County facilities. The space standards illustrated are:

- Offices and workstations which are assigned to individuals
- A selection of conference rooms and shared work areas
- A selection of copier and support functions
- A selection of break rooms

Personnel space standards are based upon generally accepted principles of prudent space allocation, and are intended to assist the County in providing and maintaining effective and efficient facilities. It is important to note that the standards are based upon functionally driven needs, and are generally not designed to simply reflect position or grade.

Support space standards play an important role in the development of programming for new facilities. These standards allow the Facilities planning and design group to identify



the department's needs, and to accommodate shared equipment and storage requirements.

While the implementation of a program of space standards is intended to have wide application in the planning of all County facilities, each space assignment should be carefully considered as a functional requirement, allowing particular functional needs to be the overriding concern. The space standards are reviewed annually as part of the Needs Analysis Update. As a result of the interviews with the departments, their changing needs may result in the addition of, or modifications to the space standards.

SPACE SCHEMATICS

Please use the following schematics for space planning.



Area:

240 Net Sq. Ft. SIZE: 12' X 20' Nominally

Anticipated Assignments:

Elected Official	County Manager
County Legal Counsel	Judge

Description:

Private office with acoustic and visual privacy
 Exterior window desired, interior glazing possible

Includes:

- Large desk
- Credenza or back table
- Conference table with seating for four
- Accommodation for computer, appropriate technology

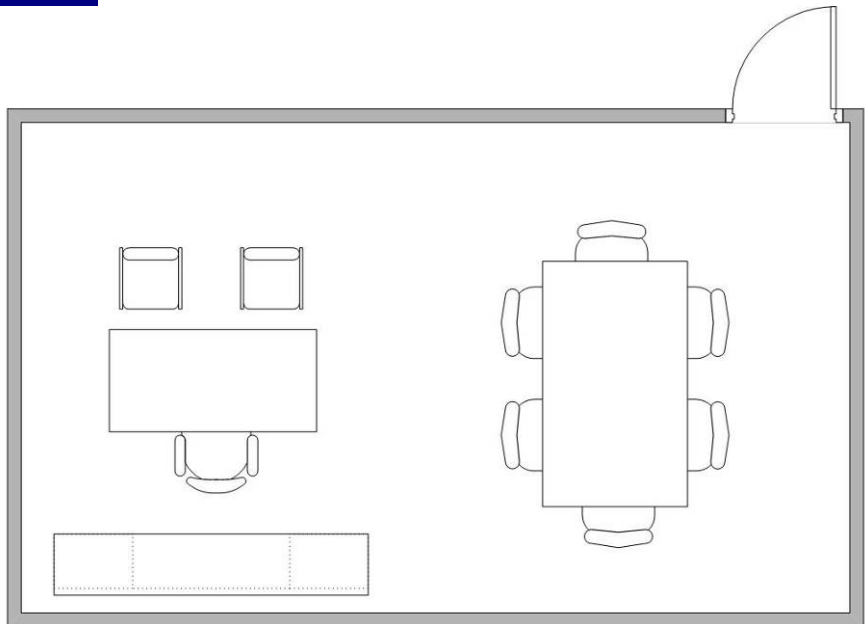

This document is intended to be used as a tool for schematic space planning. Actual sizes may vary depending on building architecture, user function as well as furniture manufacturers identified by the County Furniture Term and Supply Contracts. The Facilities Department determines furniture typicals and kit of parts for existing and future building based off of programmed need.



Area:	180 Net Sq. Ft. SIZE: 12' X 15' Nominally	
Anticipated Assignments:	Deputy County Manager	Appointed Official
	Assistant County Manager	Agency or Department Director
Description:	Private office with acoustic and visual privacy Exterior window desired, interior glazing possible	
Includes:	Medium desk or systems furniture grouping Credenza or back table Small conference table and seating or lounge furniture group Accommodation for computer, appropriate technology	

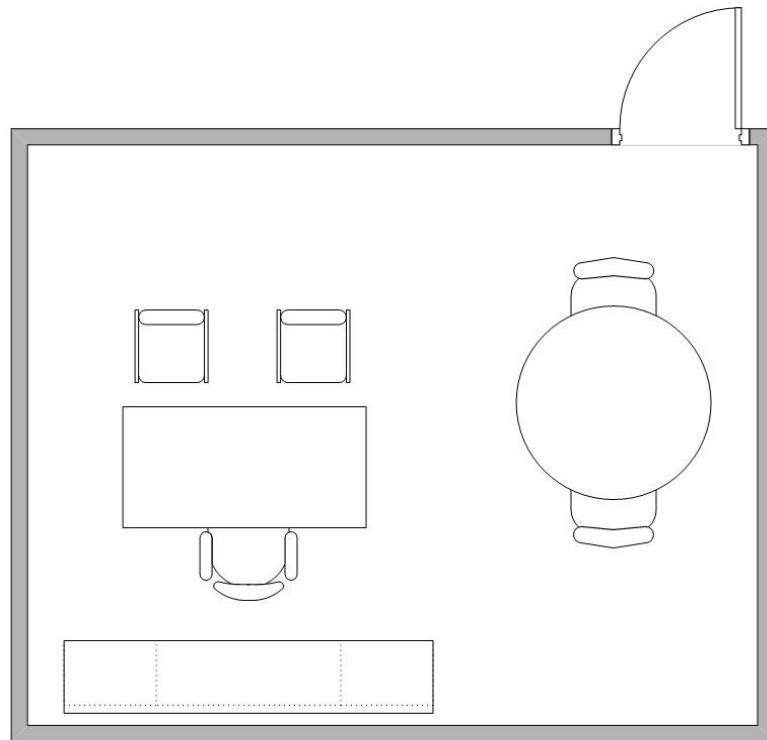

This document is intended to be used as a tool for schematic space planning. Actual sizes may vary depending on building architecture, user function as well as furniture manufacturers identified by the County Furniture Term and Supply Contracts. The Facilities Department determines furniture typicals and kit of parts for existing and future building based off of programmed need.



Area:

120 Net Sq. Ft. SIZE: 12' X 10' Nominally

Anticipated Assignments:

Assistant Department Director Physician
 Attorney All professional ≥ Grade 20

Description:

Private office with acoustic and visual privacy
 Exterior window desired, interior glazing possible

Includes:

- Medium desk or systems furniture grouping
- Credenza or back table
- File cabinet or book case
- Accommodation for computer, appropriate technology

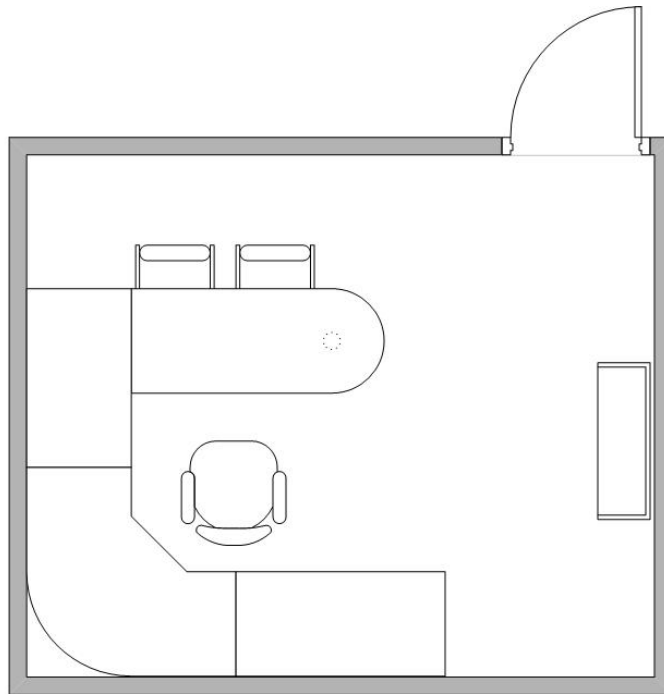

This document is intended to be used as a tool for schematic space planning. Actual sizes may vary depending on building architecture, user function as well as furniture manufacturers identified by the County Furniture Term and Supply Contracts. The Facilities Department determines furniture typicals and kit of parts for existing and future building based off of programmed need.



Area:	90 Net Sq. Ft. SIZE: 7'10" X 12'4" Nominally
Anticipated Assignments:	Professional/Manager (Grade 15 – 19)
Description:	Open wok station with sound absorptive partitions Unitized systems furniture
Includes:	Integral work surfaces Coordinated storage Accommodation for computer, appropriate technology

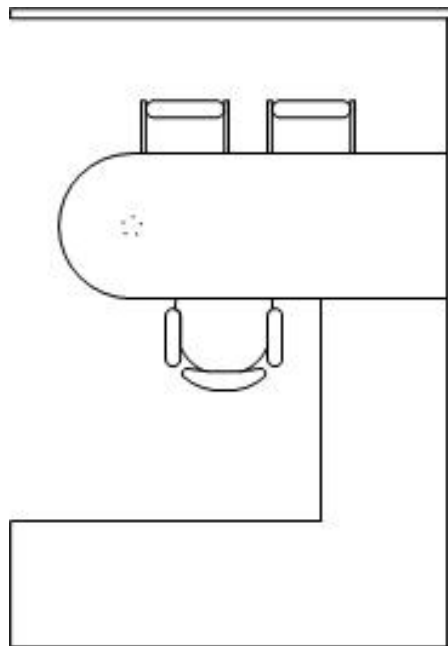

This document is intended to be used as a tool for schematic space planning. Actual sizes may vary depending on building architecture, user function as well as furniture manufacturers identified by the County Furniture Term and Supply Contracts. The Facilities Department determines furniture typicals and kit of parts for existing and future building based off of programmed need.



Area:	63.75 Net Sq. Ft. SIZE: 7'10" X 8'10" Nominally
Anticipated Assignments:	Technical/Supervisory (Grade 12 – 16)
Description:	Open wok station with sound absorptive partitions Unitized systems furniture
Includes:	Integral work surfaces Coordinated storage Accommodation for computer, appropriate technology

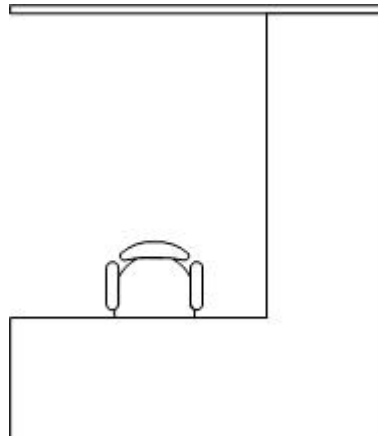

This document is intended to be used as a tool for schematic space planning. Actual sizes may vary depending on building architecture, user function as well as furniture manufacturers identified by the County Furniture Term and Supply Contracts. The Facilities Department determines furniture typicals and kit of parts for existing and future building based off of programmed need.



Area:	52.5 Net Sq. Ft. SIZE: 7'10" X 7'4" Nominally
Anticipated Assignments:	Clerk/Secretary (Grade 10 – 14)
Description:	Open wok station with sound absorptive partitions Unitized systems furniture
Includes:	Integral work surfaces Coordinated storage Accommodation for computer, appropriate technology

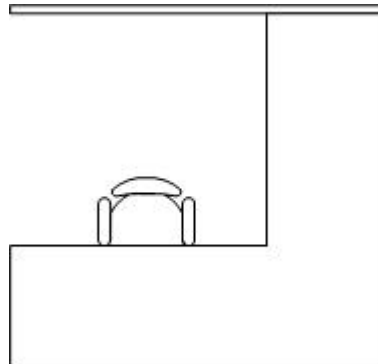

This document is intended to be used as a tool for schematic space planning. Actual sizes may vary depending on building architecture, user function as well as furniture manufacturers identified by the County Furniture Term and Supply Contracts. The Facilities Department determines furniture typicals and kit of parts for existing and future building based off of programmed need.



Area:	30 Net Sq. Ft. SIZE: 6' X 5' Nominally
Anticipated Assignments:	Consultant/Volunteer
Description:	Carrel station along work counter with vertical dividers My be built-in or systems furniture
Includes:	Counter at 24" or 30" wide Optional under-counter storage Optional bookshelf over counter Accommodation for computer, appropriate technology

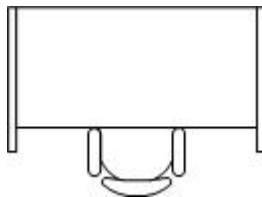

This document is intended to be used as a tool for schematic space planning. Actual sizes may vary depending on building architecture, user function as well as furniture manufacturers identified by the County Furniture Term and Supply Contracts. The Facilities Department determines furniture typicals and kit of parts for existing and future building based off of programmed need.



Area:

500 Net Sq. Ft. SIZE: 20' X 25' Nominally

Anticipated Assignments:

Shared departmental conference room

Description:

Enclosed room with acoustic and visual privacy
Interior glazing possible

Includes:

- Table and seating for 12 – 16
- Sideboard or counter
- Tackable wall surfaces
- Wall-mounted white board
- Special lighting and HVAC controls
- Integrated presentation technologies
- Accommodation for computer, teleconferencing

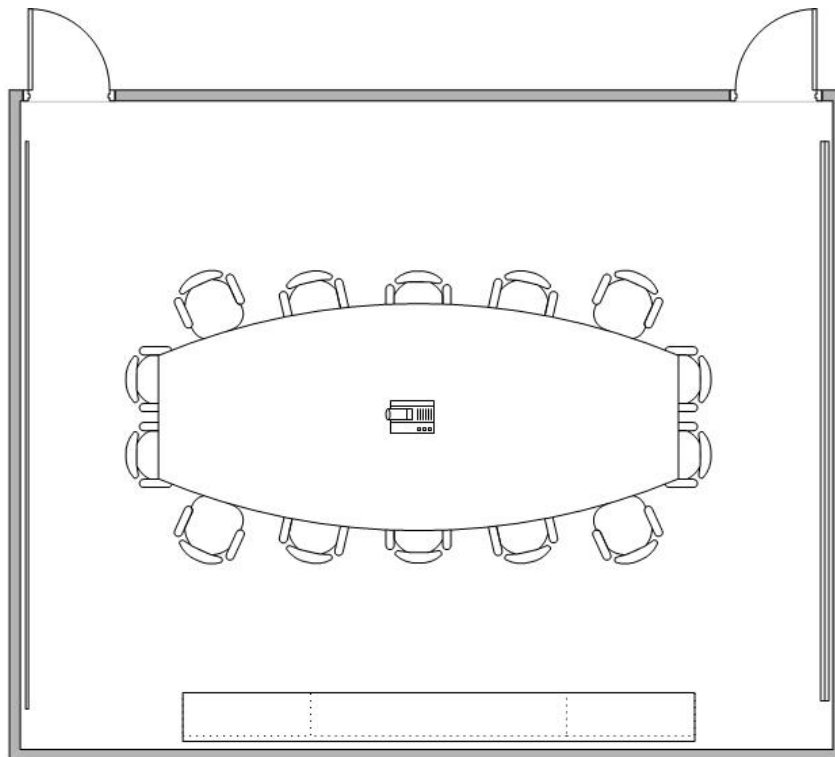

This document is intended to be used as a tool for schematic space planning. Actual sizes may vary depending on building architecture, user function as well as furniture manufacturers identified by the County Furniture Term and Supply Contracts. The Facilities Department determines furniture typicals and kit of parts for existing and future building based off of programmed need.



Area:

225 Net Sq. Ft. SIZE: 15' X 15' Nominally

Anticipated Assignments:

Departmental conference room

Description:

Enclosed room with acoustic and visual privacy
Interior glazing possible

Includes:

- Table and seating for 6 – 8
- Sideboard or counter
- Tackable wall surfaces
- Wall-mounted white board
- Special lighting and HVAC controls
- Integrated presentation technologies
- Accommodation for computer, teleconferencing

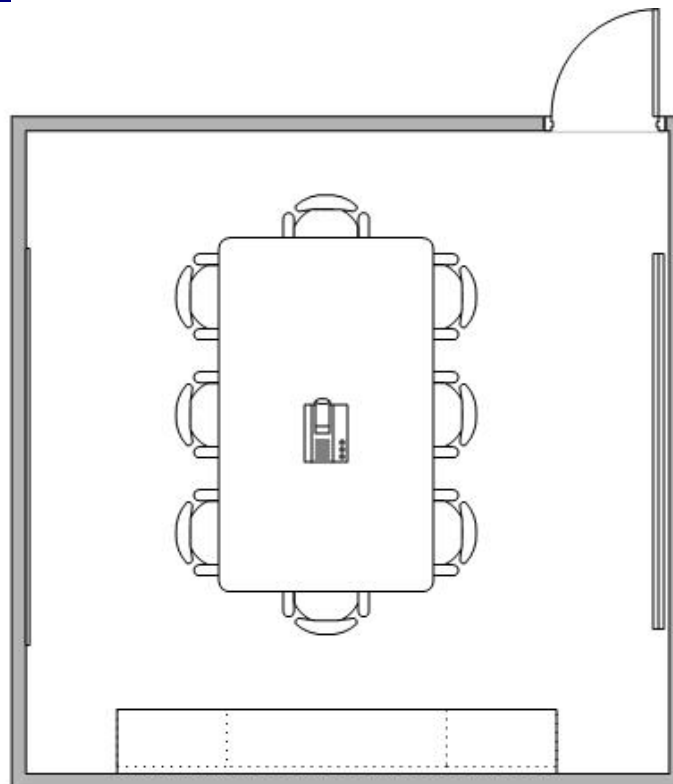

This document is intended to be used as a tool for schematic space planning. Actual sizes may vary depending on building architecture, user function as well as furniture manufacturers identified by the County Furniture Term and Supply Contracts. The Facilities Department determines furniture typicals and kit of parts for existing and future building based off of programmed need.



Area: 100 Net Sq. Ft. SIZE: 10' X 10' Nominally

Anticipated Assignments: Small conference room

Description: Enclosed room with acoustic and visual privacy
Interior glazing possible

Includes: Table and seating for 3 – 5
Wall-mounted white board
Accommodation for computer, teleconferencing

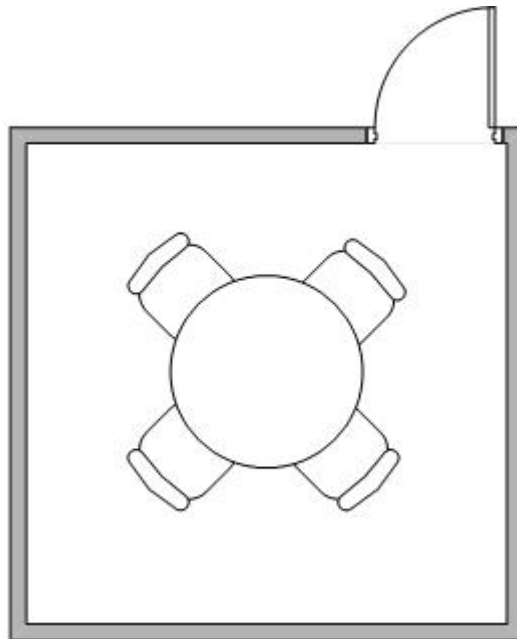

This document is intended to be used as a tool for schematic space planning. Actual sizes may vary depending on building architecture, user function as well as furniture manufacturers identified by the County Furniture Term and Supply Contracts. The Facilities Department determines furniture typicals and kit of parts for existing and future building based off of programmed need.



Area: 225 Net Sq. Ft. SIZE: 15' X 15' Nominally

Anticipated Assignments: Departmental conference room

Description: Enclosed room with acoustic and visual privacy
Interior glazing possible

Includes: Table and seating for 6 – 8
Sideboard or counter
Tackable wall surfaces
Wall-mounted white board
Special lighting and HVAC controls
Integrated presentation technologies
Accommodation for computer, teleconferencing

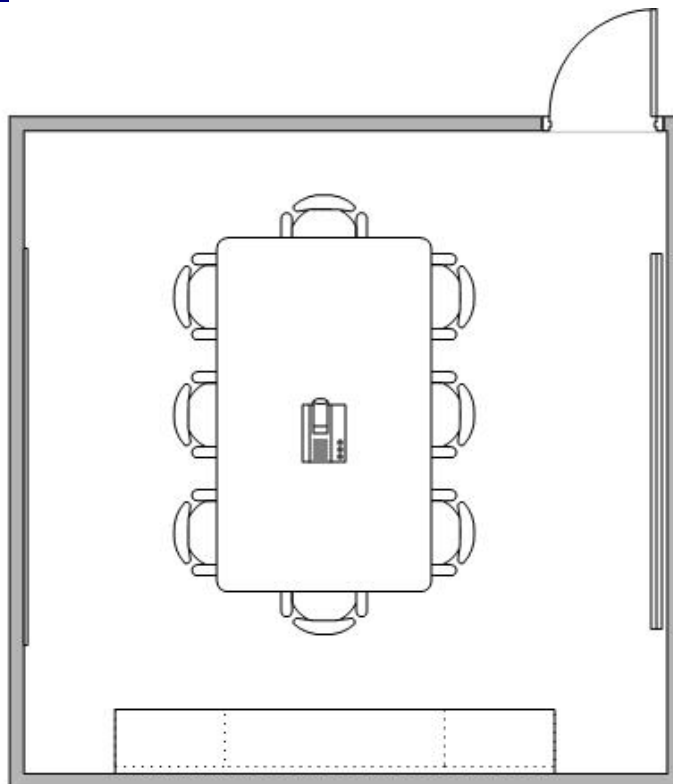

This document is intended to be used as a tool for schematic space planning. Actual sizes may vary depending on building architecture, user function as well as furniture manufacturers identified by the County Furniture Term and Supply Contracts. The Facilities Department determines furniture typicals and kit of parts for existing and future building based off of programmed need.



Area:	100 Net Sq. Ft. SIZE: 10' X 10' Nominally
Anticipated Assignments:	Small meeting room
Description:	Enclosed room with acoustic and visual privacy Interior glazing possible
Includes:	Table and seating for 2 – 3 Wall-mounted white board Accommodation for computer, teleconferencing

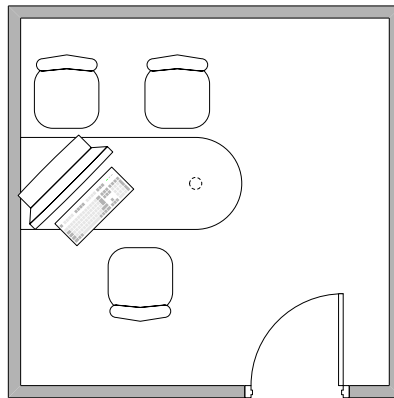

This document is intended to be used as a tool for schematic space planning. Actual sizes may vary depending on building architecture, user function as well as furniture manufacturers identified by the County Furniture Term and Supply Contracts. The Facilities Department determines furniture typicals and kit of parts for existing and future building based off of programmed need.



Area:

225 Net Sq. Ft. SIZE: 15' X 15' Nominally

Anticipated Assignments:

Departmental conference room

Description:

Enclosed room with acoustic and visual privacy
Interior glazing possible

Includes:

- Table and seating for 6 – 8
- Sideboard or counter
- Tackable wall surfaces
- Wall-mounted white board
- Special lighting and HVAC controls
- Integrated presentation technologies
- Accommodation for computer, teleconferencing

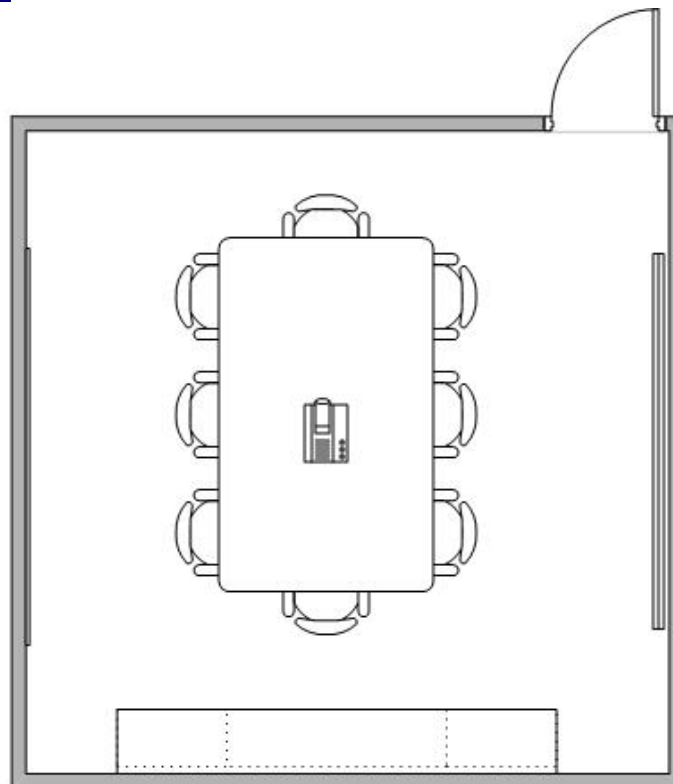

This document is intended to be used as a tool for schematic space planning. Actual sizes may vary depending on building architecture, user function as well as furniture manufacturers identified by the County Furniture Term and Supply Contracts. The Facilities Department determines furniture typicals and kit of parts for existing and future building based off of programmed need.



Area: 120 Net Sq. Ft. SIZE: 10' X 12' Nominally

Anticipated Assignments: Large departmental support area

Description: Open or enclosed area with accommodation for office equipment

Includes: Storage cabinets, counter, shelving
Appropriate data and power provisions

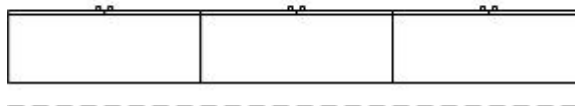
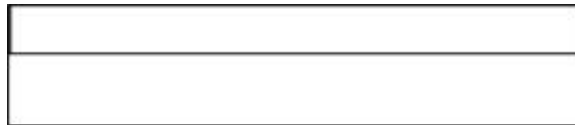

This document is intended to be used as a tool for schematic space planning. Actual sizes may vary depending on building architecture, user function as well as furniture manufacturers identified by the County Furniture Term and Supply Contracts. The Facilities Department determines furniture typicals and kit of parts for existing and future building based off of programmed need.



Area:	800 Net Sq. Ft. SIZE: 10' X 8' Nominally
Anticipated Assignments:	Departmental support area
Description:	Open or enclosed area with accommodation for office equipment
Includes:	Storage cabinets, counter, shelving Appropriate data and power provisions

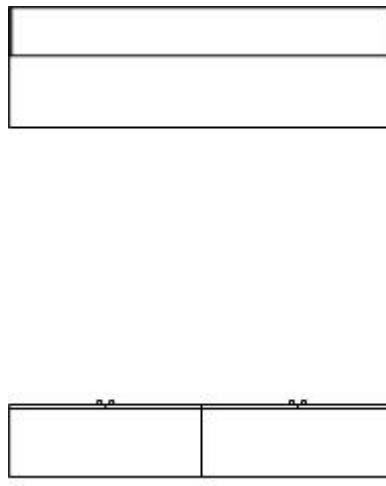

This document is intended to be used as a tool for schematic space planning. Actual sizes may vary depending on building architecture, user function as well as furniture manufacturers identified by the County Furniture Term and Supply Contracts. The Facilities Department determines furniture typicals and kit of parts for existing and future building based off of programmed need.

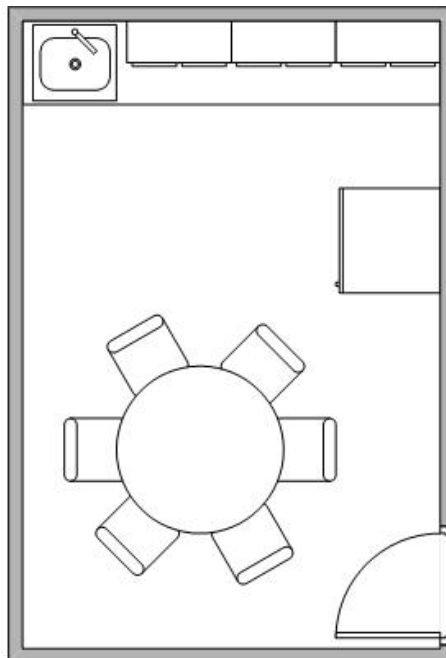

BREAK ROOM AND KITCHEN – 150 SQFT**BRK-004****Area:** 150 Net Sq. Ft. SIZE: 10' X 15' Nominally**Anticipated Assignments:** Departmental and shared support area**Description:** Enclosed area with water-resistant finishes**Includes:**
Storage cabinets, counter, shelving
Sink with domestic water
Refrigerator
Small table with seating for 4 – 6

This document is intended to be used as a tool for schematic space planning. Actual sizes may vary depending on building architecture, user function as well as furniture manufacturers identified by the County Furniture Term and Supply Contracts. The Facilities Department determines furniture typicals and kit of parts for existing and future building based off of programmed need.



Area:	48 Net Sq. Ft. SIZE: 6' X 8' Nominally
Anticipated Assignments:	Departmental and shared support area
Description:	Enclosed area with water-resistant finishes
Includes:	Storage cabinets, counter, shelving Sink with domestic water Refrigerator

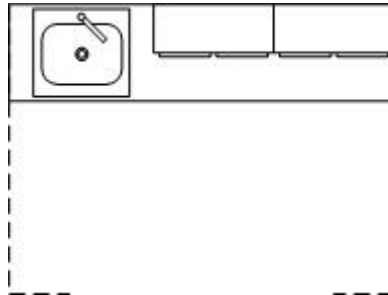

This document is intended to be used as a tool for schematic space planning. Actual sizes may vary depending on building architecture, user function as well as furniture manufacturers identified by the County Furniture Term and Supply Contracts. The Facilities Department determines furniture typicals and kit of parts for existing and future building based off of programmed need.



SPACE ASSIGNMENT GUIDELINES AND STANDARDS

Personnel Space			
Room Standard Code	Room Standard Description	Area	Gross Factor
POFC0100	Private Office 100 SF	100.00	1.35
POFC0120	Private Office 120 SF	120.00	1.35
POFC0180	Private Office 180 SF	180.00	1.35
POFC0240	Private Office 240 SF	240.00	1.35
POFC0360	Private Office 360 SF	360.00	1.35
WS01	WS Typ. 01 53 SF	52.50	1.40
WS01MOD	Modified WS01 for Aspire	48.00	1.40
WS02	WS Typ. 02 64 SF	63.75	1.40
WS03	WS Typ. 03 90 SF	90.00	1.40
WS04	WS Typ. 04 120 SF	120.00	1.40
WS05	WS Typ 05 - CARREL 30 SF	30.00	1.40

Space based on inmate bed count			
Room Standard Code	Room Standard Description	Area	Gross Factor
ADTADMIN	AdltDet Admin	10.40	1.00
ADTBED	AdltDet Inmate Bed	243.50	1.00
ADTBLDG	AdltDet Maint/Plant	17.40	1.00
ADTC&C	AdltDet Custody&Control	24.30	1.00
ADTINTK	AdltDet Intake&Transfer	36.50	1.00
ADTMED	AdltDet Health Services	12.20	1.00
ADTPROG	AdltDet Inmate Programs	48.70	1.00
ADTSPT	AdltDet Support Services	41.70	1.00
ARCAADMIN	AdltRes Admin spc/resid	13.90	1.43
ARCBDSF	AdltRes SF per bed (ARC4)	140.40	1.00
ARCBED	AdltRes Resident Bed	156.50	1.43
ARCBLDG	AdltRes Maint/Plant	6.90	1.43
ARCC&C	AdltRes Custody&Classfctn	17.40	1.43
ARCMED	AdltRes Hlth Svc	13.90	1.43
ARCRECP	AdltRes Reception	3.50	1.43
ARCRECR	AdltRes Recreation	0.00	1.43
ARCSPT	AdltRes Support Srvcs	17.40	1.43
ARCTRMNT	AdltRes Treatment Srvcs	20.90	1.43
JUVADMIN	JuvDet Admin	20.00	1.35
JUVBED	JuvDet Juvenile Bed	260.00	1.35
JUVBLDG	JuvDet Maint/Plant	32.00	1.35
JUVC&C	JuvDet Custody&Classfctn	28.00	1.35
JUVCLAS	JuvDet Education	80.00	1.35
JUVDINE	JuvDet Dining	16.00	1.35
JUVMED	JuvDet Health Services	28.00	1.35
JUVRCR	JuvDet Recreation	56.00	1.35
JUVRECP	JuvDet Reception	16.00	1.35
JUVSPT	JuvDet Support Services	74.00	1.35
JUVTRMNT	JuvDet Treatment Srvcs	28.00	1.35
JUVVIS	JuvDet Visiting	24.00	1.35



Space based on Occupancy			
Room Standard Code	Room Standard Description	Area	Gross Factor
AUD-050	50 Person Auditorium	1100.00	1.65
AUD-200	200 Person Auditorium	2500.00	1.65
BRK-001	Break -Coffee Bar 48 SF	48.00	1.35
BRK-003	Break Area - 100 SF	100.00	1.35
BRK-004	Break Area - 150 SF	150.00	1.35
BRK-006	Break Area - 225 SF	225.00	1.35
BRK-008	Break Area - 300 SF	300.00	1.35
BRK-009	Break Area - 325 SF	325.00	1.35
BRK-012	Break Area - 420 SF	420.00	1.20
BRK-024	Break Area - 720 SF	720.00	1.20
BRK-060	Break Area - 1200	1200.00	1.20
BRK-100	Break area - 3500 SF	3500.00	1.20
BRK-180	Break Area - 5500	5500.00	1.20
CELL-001	1 Person Holding 60 SF	60.00	1.35
CELL-005	Group Holding 100 SF	100.00	1.35
CELL-008	Group Holding 168 SF	168.00	1.35
CELL-012	Group Holding 480 SF	480.00	1.35
CLSRM-004	4 Pers Classroom 175 SF	175.00	1.35
CLSRM-006	6 Pers Classroom 220 SF	220.00	1.35
CLSRM-010	10 Pers Classroom 350 SF	350.00	1.35
CLSRM-014	14 Pers Classroom 500 SF	500.00	1.35
CLSRM-018	18 Pers Classroom 650 SF	650.00	1.35
CLSRM-020	20 Pers Classroom 750 SF	750.00	1.35
CLSRM-030	30 Pers Classroom - 600 S	600.00	1.35
CLSRM-040	40 Pers Classroom 1200 SF	1200.00	1.35
CLSRM-050	50 Pers Classroom 1750 SF	1750.00	1.35
CLSRM-300	300 Pers Classroom 6000 SF	6000.00	1.10
CNF-004	4 Pers Conf Room 100 SF	100.00	1.35
CNF-006	6 Pers Conf Room 150 SF	150.00	1.35
CNF-008	8 Pers Conf Room 225 SF	225.00	1.35
CNF-012	12 Pers Conf Room 300 SF	300.00	1.35
CNF-014	14 Pers Conf Room 350 SF	350.00	1.35
CNF-020	20 Pers Conf Room 500 SF	500.00	1.35
CNF-022	22 Pers Conf Room 700 SF	700.00	1.35

Space based on Occupancy			
Room Standard Code	Room Standard Description	Area	Gross Factor
JDBEDRM-1	Juv Res 1 Bed Bedroom	80.00	1.35
JDBEDRM-2	Juv Res 2 Bed Bedroom	120.00	1.35
JDBEDRM-3	Juv Res 3 Bed Bedroom	180.00	1.35
JDBEDRMADA	Juv Res. Bedroom ADA	165.00	1.35
MP-020	Multi Purpose Rm 400 SF	400.00	1.35
MP-030	Multi Purpose Rm 600 SF	600.00	1.20
MP-040	Multi Purpose Rm 800 SF	800.00	1.20
MP-050	Multi Purpose Rm 1000 SF	1000.00	1.20
MP-060	Multi Purpose Rm 1200 SF	1200.00	1.20
MP-075	Multi Purpose Rm 1500 SF	1500.00	1.10
MP-080	Multi Purpose Rm 1600 SF	1600.00	1.10
MP-100	Multi Purpose Rm 2000 SF	2000.00	1.10
MP-120	Multi Purpose Rm 2400 SF	2400.00	1.10
MP-150	Multi Purpose Rm 3000 SF	3000.00	1.10
MP-250	Multi Purpose Rm 4800 SF	4800.00	1.10
MP-300	Multi Purpose Rm 6000 SF	6000.00	1.10
NCBEDROOM1	Nursing Ctr. 1 Person Bed	153.00	1.35
NCBEDROOM2	Nursing Ctr. 2 Person Bed	400.00	1.35
PAT-004	Pub Access Term 120 SF	120.00	1.35
PAT-008	Pub Access Term 240 SF	240.00	1.35
PAT-SIT	Pub Access Single Sitting	30.00	1.35
PAT-STND	Pub Access Single Stand	15.00	1.35
REC-0002	Reception Area 60 SF	60.00	1.35
REC-0004	Reception Area 120 SF	120.00	1.35
REC-0006	Reception Area 180 SF	180.00	1.35
REC-0008	Reception Area 240 SF	240.00	1.35
REC-0010	Reception Area 300 SF	300.00	1.35
REC-0012	Reception Area 360 SF	360.00	1.35
REC-0016	Reception Area 480 SF	480.00	1.35
REC-0020	Reception Area 600 SF	600.00	1.20
REC-0024	Reception Area 720 SF	720.00	1.20
REC-0032	Reception Area 960 SF	960.00	1.35
REC-0080	Reception Area 2400 SF	2400.00	1.35
REC-SIT	Rcptn Area - 1 pers sit	30.00	1.35
REC-STND	Rcptn Area - 1 pers stand	15.00	1.35



Space based on Square Footage			
Room Standard Code	Room Standard Description	Area	Gross Factor
CLINIC0240	Health Clinic 240 SF	240.00	1.35
CLSRM-IT	IT Training WS 10 SF	10.00	1.35
CLSRMVTC	1 Pers VOTECH Class Space	48.00	1.35
CRTCRJ2000	Crim w/Jury 2000 SF (old)	2000.00	1.35
CRTCJV2000	Civil w/Jury 2000 SF (old)	2000.00	1.35
CRTHEAR400	Hearing Room 400 SF(old)	400.00	1.35
CRTHEAR800	Hearing Room 800 SF(old)	800.00	1.35
CRTNOJ1200	Non Jury 1200 SF (old)	1200.00	1.35
CRTNOJ1600	Non Jury 1600 SF (old)	1600.00	1.35
CRTNOJ2000	Non Jury 2000 SF (old)	2000.00	1.35
CRTRM1800	Std Courtroom - 1800 SF	1800.00	1.35
CRTRM2200	Large Courtroom - 2200 SF	2200.00	1.35
CRTRM3000	XLG Courtroom - 3000 SF	3000.00	1.35
CRTSPT2500	Spec Trial 2500 SF (old)	2500.00	1.35
DINING0600	Dining Area 600 SF	600.00	1.35
DINING1200	Dining Area 1200 SF	1200.00	1.20
DINING1600	Dining Area 1600 SF	1600.00	1.20
DINING2000	Dining Area 2000 SF	2000.00	1.20
DINING3500	Dining Area 3500 SF	3500.00	1.20
DMPSTRBAY	Dumpster Bay - 200 SF	200.00	1.20
DOCK00250	Loading Dock 250 SF	250.00	1.20
DOCK00500	Loading Dock 500 SF	500.00	1.20
DOCK01000	Loading Dock 1000 SF	1000.00	1.20
ELEQ00030	Tech Equip Room 30 SF	30.00	1.35
ELEQ00100	Tech Equip Room 100 SF	100.00	1.35
ELEQ00120	Tech Equip Room 120 SF	120.00	1.35
ELEQ00200	Tech Equip Room 200 SF	200.00	1.35
ELEQ00250	Tech Equip Room 250 SF	250.00	1.35
ELEQ00400	Tech Equip Room 400 SF	400.00	1.35
ELEQ00600	Tech Equip Room 600 SF	600.00	1.35
ELEQ00750	Tech Equip Room 750 SF	750.00	1.35
ELEQ01000	Tech Equip Room 1000 SF	1000.00	1.35
ELEQ01500	Tech Equip Room 1500 SF	1500.00	1.35
ELEQ02100	Tech Equip Room 2100 SF	2100.00	1.35
ELEQ02500	Tech Equip Room 2500 SF	2500.00	1.35

Space based on Square Footage			
Room Standard Code	Room Standard Description	Area	Gross Factor
EXAM00120	Examination Room 120 SF	120.00	1.35
EXAM00180	Examination Room 180 SF	180.00	1.35
EXERC0350	Exercise Room - 350 SF	350.00	1.20
EXERC1000	Exercise Room - 1000 SF	1000.00	1.20
EXERC1500	Exercise Room - 1500 SF	1500.00	1.20
EXHBT01200	Exhibition Area 1200 SF	1200.00	1.10
EXHBT02500	Exhibition Area 2500 SF	2500.00	1.10
EXHBT10000	Exhibition Hall 10000 SF	10000.00	1.10
FILFLT-01	Flat File Unit (ea)	36.00	1.35
FILHD-01	Hi Dnsty File Unit (Ea)	25.00	1.35
FILHD-10	Hi Dnsty File 240 SF	240.00	1.00
FILLAT-001	Lateral File Unit (ea)	16.00	1.35
FILVRT-001	Vertical File Unit w/circ	12.00	1.35
FILVRT-002	File Space 24 SF	24.00	1.35
FILVRT-004	File Space 48 SF	48.00	1.35
FILVRT-008	File Space 96 SF	96.00	1.00
FILVRT-016	File Space 192 SF	192.00	1.00
FILVRT-032	File Space 384 SF	384.00	1.00
GARAGE0336	Single Bay Garage 336 SF	336.00	1.35
GARAGE0772	Double Bay garage 772 SF	772.00	1.35
GARAGE1200	5 Bay Garage 1200 SF	1200.00	1.20
GYM0000850	Gymnasium 850 SF	850.00	1.20
GYM0001200	Gymnasium 1200 SF	1200.00	1.20
HEAR001500	Hearing Room 1500 SF	1500.00	1.35
INTAKE0075	Secure Intake Area 75 SF	75.00	1.35
INTAKE0120	Secure Intake Area 120 SF	120.00	1.35
INTAKE0240	Secure Intake Area 240 SF	240.00	1.35
INTRV0048	Interview Room 48 SF	48.00	1.35
INTRV0060	Interview Room 60 SF	60.00	1.35
INTRV0080	Interview Room 80 SF	80.00	1.35
INTRV0100	Interview Room 100 SF	100.00	1.35
JDDAYRM120	Juv Res Dayroom - 120 SF	120.00	1.35
JDDAYRM200	Juv Res Dayroom - 200 SF	200.00	1.35
JDDAYRM400	Juv Res Dayroom - 400 SF	400.00	1.35
JURYROOM	14 Person Jury Room	280.00	1.35



Space based on Square Footage			
Room Standard Code	Room Standard Description	Area	Gross Factor
KITCHN0120	Kitchen 120 SF	120.00	1.35
KITCHN0200	Kitchen 200 SF	200.00	1.35
KITCHN0500	Kitchen 500 SF	500.00	1.35
KITCHN2000	Kitchen 2000 SF	2000.00	1.35
KITCHN2500	Kitchen 2500 SF	2500.00	1.35
KITCHN3000	Kitchen 3000 SF	3000.00	1.00
LAB00120	Laboratory 120 SF	120.00	1.35
LAB00240	Laboratory 240 SF	240.00	1.35
LAB00360	Laboratory 360 SF	360.00	1.35
LAB00550	Laboratory 550 SF	550.00	1.35
LAB00700	Laboratory 700 SF	700.00	1.35
LAB00800	Laboratory 800 SF	800.00	1.35
LAB00900	Laboratory 900 SF	900.00	1.35
LAB01500	Laboratory 1500 SF	1500.00	1.35
LAB02000	Laboratory 2000 SF	2000.00	1.35
LABCOMP	Computer Lab WS 25 SF	25.00	1.35
LCKR-001	Single Locker 13 SF	13.00	1.35
LCKR00100	Locker Room 100 SF	100.00	1.35
LCKR00240	Locker Room 240 SF	240.00	1.35
LCKR00400	Locker Room 400 SF	400.00	1.35
LCKR00500	Locker Room 500 SF	500.00	1.35
LCKR00600	Locker Room 600 SF	600.00	1.35
LCKR00750	Locker Room 750 SF	750.00	1.35
LCKR01000	Locker Room 1000 SF	1000.00	1.35
LCKR01350	Locker Room 1350 SF	1350.00	1.35
LIBRY00100	10 Unit Library 100 SF	100.00	1.35
LIBRY00200	20 Unit Library 200 SF	200.00	1.35
LIBRY00300	30 Unit Library 300 SF	300.00	1.35
LIBRY00400	40 Unit Library 400 SF	400.00	1.35
LIBRY00600	60 Unit Library 600 SF	600.00	1.35
LIBRY00800	80 Unit Library 800 SF	800.00	1.35
LIBRY01600	Library 1600 SF	1600.00	1.10
LIBRYUNIT	Library Shelf Unit w/circ	9.00	1.35
LNDRY00100	Laundry Area 100 SF	100.00	1.35
LNDRY00200	Laundry Area 200 SF	200.00	1.35

Space based on Square Footage			
Room Standard Code	Room Standard Description	Area	Gross Factor
LNDRY00300	Laundry Area 300 SF	300.00	1.35
MECH00300	Mechanical Equip 300 SF	300.00	1.35
MECH00800	Mechanical Equip 800 SF	800.00	1.35
MP01	Multi Purpose Room	500.00	1.35
MP02	Multi Purpose Room	910.00	1.35
NC THERAPY	NC Physical Therapy	400.00	1.35
NCBATHING	NC Bathing Area	213.00	1.35
NCBATHINGR	Nursing Center Bathing Rm	213.00	1.35
NCPRIVREST	NC Private Restroom	38.00	1.35
NURSE0150	Nurse Station 150 SF	150.00	1.35
RETAIL0280	Retail Store 280 SF	280.00	1.35
RETAIL0400	Retail Store 400 SF	400.00	1.20
RSTRM0060	Restroom 60 SF	60.00	1.35
RSTRM0120	Restroom 120 SF	120.00	1.35
RSTRM0180	Restroom 180 SF	180.00	1.35
RSTRM0240	Restroom 240 SF	240.00	1.35
RSTRM0400	Restroom 400 SF	400.00	1.35
RSTRMPVT	Private Restroom	48.00	1.35
RSTRMSP	Restroom for Special Need	1200.00	1.35
SCURTY0030	Secure Area - 30 SF	30.00	1.35
SCURTY0060	Secure Area - 60 SF	60.00	1.35
SCURTY0120	Security Station 120 SF	120.00	1.35
SCURTY0240	Security Station 240 SF	240.00	1.35
SCURTY0320	Secure Area 320 SF	320.00	1.35
SECVEH3500	Sec Veh Sallyport 3500 SF	3500.00	1.35
SHOP00240	Shop Area 240 SF	240.00	1.35
SHOP00480	Shop Area 480SF	480.00	1.20
SHOP00600	Shop Area 600 SF	600.00	1.20
SHOP01000	Shop Area 1000 SF	1000.00	1.20
SHOP01200	Shop Area 1200 SF	1200.00	1.20
SHOP01600	Shop Area 1600 SF	1600.00	1.10
SHOP01800	Shop Area 1800 SF	1800.00	1.10
SHPSP04500	Shop Spec Need 4500 SF	4500.00	1.10
SHPSP21000	Shop Spec Need 21000 SF	21000.00	1.10
ST-ARM0080	Storage - Armory 80 SF	80.00	1.35



Space based on Square Footage			
Room Standard Code	Room Standard Description	Area	Gross Factor
ST-ARM0200	Storage - Armory 200 SF	200.00	1.35
ST-BIO0050	Storage - Biohazard 50SF	50.00	1.35
ST-BIO0080	Storage - Biohazard 80 SF	80.00	1.35
ST-BIO0100	Storage - Biohazard 100SF	100.00	1.35
ST-BIO0160	Storage - Biohazard 160SF	160.00	1.35
ST-BIO0300	Storage - Biohazard 300SF	300.00	1.35
ST-BKCS	Storage - Bookcase Unit	9.00	1.35
ST-FLAM008	Storage - Flam Locker 8SF	8.00	1.35
ST-FLAM080	Storage- Flam Mtl 80 SF	80.00	1.35
ST-FLAM120	Storage- Flam Mtl -120 SF	120.00	1.35
ST-VLT0100	Storage - Vault Small	100.00	1.35
ST-VLT0200	Storage - Vault Medium	200.00	1.35
ST-VLT0300	Storage - Vault Large	300.00	1.35
STOR-SML	Small Closet	10.00	1.35
STOR00020	Storage Room 20 SF	20.00	1.35
STOR00050	Storage Room 50 SF	50.00	1.35
STOR00100	Storage Room 100 SF	100.00	1.35
STOR00150	Storage Room 150 SF	150.00	1.35
STOR00200	Storage Room 200 SF	200.00	1.35
STOR00300	Storage Room 300 SF	300.00	1.35
STOR00400	Storage Room 400 SF	400.00	1.35
STOR00500	Storage Room 500 SF	500.00	1.20
STOR00600	Storage Room 600 SF	600.00	1.20
STOR00700	Storage Room 700 SF	700.00	1.20
STOR00800	Storage Room 800 SF	800.00	1.20
STOR00900	Storage Room 900 SF	900.00	1.20
STOR01000	Storage Room 1000 SF	1000.00	1.20
STOR01250	Storage Room 1250 SF	1250.00	1.10
STOR01500	Storage Room 1500 SF	1500.00	1.10
STOR01750	Storage Room1750 SF	1750.00	1.10
STOR02000	Storage Room 2000 SF	2000.00	1.10
STOR02500	Storage Room 2500 SF	2500.00	1.10
STOR03000	Storage Room 3000 SF	3000.00	1.10
STOR05000	Storage Area 5000 SF	5000.00	1.10
STOR07500	Storage Area 7500 SF	7500.00	1.10

Space based on Square Footage			
Room Standard Code	Room Standard Description	Area	Gross Factor
STOR10000	Storage Area 10,000 SF	10000.00	1.10
STOR12500	Storage Area 12,500 SF	12500.00	1.10
STOR15000	Storage Area 15,000 SF	15000.00	1.10
VENDING	15 SF per Machine	15.00	1.10
VESTIBULE	Building Entry	0.00	1.35
WKCP00020	Work/Copy/Eq Area 20 SF	20.00	1.35
WKCP00040	Work/Copy/Eq Area 40 SF	40.00	1.35
WKCP00080	Work/Copy/Eq Area 80 SF	80.00	1.35
WKCP00120	Work/Copy/Eq Area 120 SF	120.00	1.35
WKCP00160	Work/Copy/Eq Area 160 SF	160.00	1.35
WKCP00200	Work/Copy/Eq Area 200 SF	200.00	1.35
WKCP00300	Work/Copy/Eq Area300 SF	300.00	1.35
WKCP00400	Work/Copy/Eq Area 400 SF	400.00	1.35
WKCP00500	Work/Copy/Eq Area 500 SF	500.00	1.35
WKCP00600	Work/Copy/Eq Area 600 SF	600.00	1.35
WKCP01500	Work/Copy/Eq Area 1500 SF	1500.00	1.20
WKPOST0250	Bldg Postal Area 250 SF	250.00	1.35
WKPOST0350	Bldg Postal Area 350 SF	350.00	1.35
WKPOST0500	Bldg Postal Area 500 SF	500.00	1.35
WKPOST1500	Bldg Postal Area 1500 SF	1500.00	1.20
WKPOST2000	Bldg Postal Area 2000 SF	2000.00	1.00
WRHS10000	Storage Warehouse 10K SF	10000.00	1.10
WRHS25000	Storage Warehouse 25K SF	25000.00	1.00
WRHS50000	Storage Warehouse 50K SF	50000.00	1.00

Virtual Space Standards			
Room Standard Code	Room Standard Description	Area	Gross Factor
PEOPLE	People	100	1.00
PEOPLEVIRT	Virtual People	0	1.00
SQFT	Square Feet	1	1.35
SQM	Square Meters	1	1.35
VIRTSPACE	No Square Foot Value	0	

